

English

**intelbras**

---

User guide

**IVP 8000 MW Pet**



**IVP 8000 MW Pet**  
**Passive infrared sensor**

Congratulations, you have just purchased a product with Intelbras quality and safety.

The IVP 8000 MW PET passive infrared motion sensor combines microwave detection with passive infrared detection, adopting advanced signal analysis technology to prevent unwanted triggers. It allows for quick and simple remote configuration via software or an app. Pet-resistant, it can be installed indoors with pets weighing up to 20kg. Enhanced tamper-proof security is provided by front and rear tamper switches. The completely wireless system simplifies and reduces installation costs.

## Care and safety

- » LGPD General Law for the Protection of Personal Data: this product does not process any personal data.
- » Follow all instructions in the manual for assembling and installing the product;
- » Fix the sensor on stable surfaces, where there are no vibrations;
- » This sensor is intended for indoor and semi-open environments;

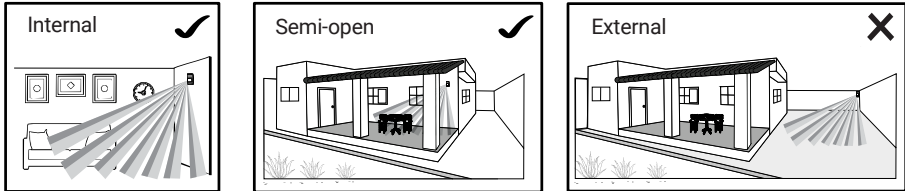

- » Do not use the sensor in areas with sudden changes in temperature, such as near air conditioners and heaters, fans, refrigerators and ovens. Do not expose the sensor to direct or reflected sunlight;

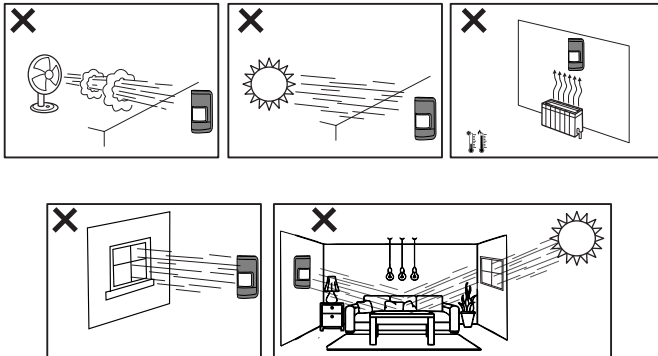

- » Do not install the sensor facing windows and glass doors;
- » Wireless communication technology, when exposed to environments with high power irradiation, may suffer interference and have its performance impaired. Example: locations close to TV towers, AM/FM radio stations, amateur radio stations, routers, etc;
- » The recommended maximum installation height is 2.20 m, do not exceed it;
- » Do not place objects in front of the sensor. Keep the detection area free of moving objects, such as bushes, clotheslines, or anything else that could block the sensor's detection;
- » The sensor must be installed where a possible intruder can be easily detected, that is, where it makes transverse movements to the detection beams (see the figure below);

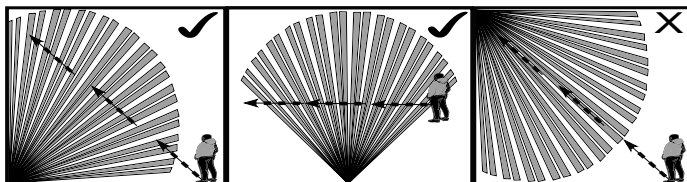

» The Pet function is intended for crawling animals weighing up to 20 kg. If the animal is on top of a bench, for example, the Pet function can be canceled.

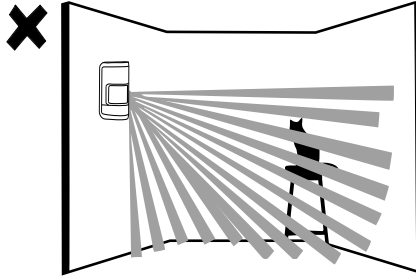

*Obs.:* before starting the installation, it is necessary to define the height at which the sensor will be positioned, which can vary from 1.8 to 2.2 m. If the sensor is installed at a height of less than 1.8 m or is tilted downwards, the Pet function will be compromised.

### Scan

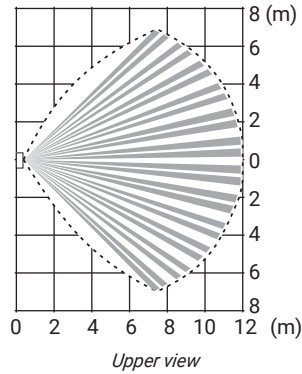

### Detection range

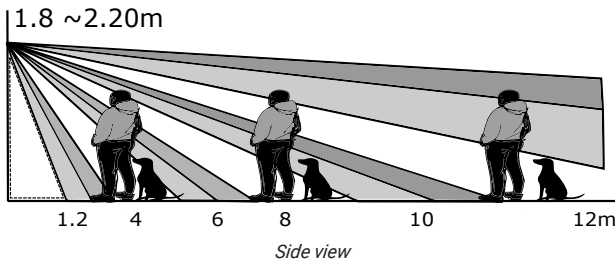

# Summary

1. Technical specifications	6
2. Characteristics	6
3. Product	7
4. Sensor aperture	7
5. Sensor stabilization	8
6. Registering the sensor	8
7. Deleting the sensor record	8
8. Identifying the best location for installation	9
9. Installation	9
10. Trial period	11
11. Test	11
12. Configuring the sensor	11
12.1. Configuring the sensor via the keyboard . . . . .	11
12.2. Information about sensor adjustments . . . . .	12
12.3. Information about LED operation and mode of operation . . . . .	12
12.4. Configuring the sensor through the app . . . . .	13
12.5. Microwave sensitivity adjustment . . . . .	14
13. Battery	16
14. Battery replacement	16
15. Homologation	16
Warranty term	17

# 1. Technical specifications

---

Operating voltage	9 Vdc
Operating current	26 mA
Current at rest	19 $\mu$ A
Frequency range	915 MHz to 928 MHz
Modulation	DSSS BPSK 40 Kbps
Maximum transmission power	11 dBm
Battery (CR123A)	Panasonic Industrial, Duracel High Power or GP Pro
Detection angle	90°
Detection range	15 m
Detection method	PIR + Microwave
Animal immunity	Up to 20 kg
Maximum startup time	60 seconds
LED indicators	LED: Yellow (PIR) / Red (MW) / Blue (Alarm)
Operating Temperature	-10 °C ~ +50 °C
RF range	1000 meters no hurdles
Dimensions (W × H × D)	68 × 55 × 120 mm

# 2. Characteristics

---

- » Automatic real-time temperature compensation.
- » Intelligent algorithm that prevents false triggers;
- » Verification of communication status through LED, keyboard and application;
- » Wireless communication with range of up to 1000 meters with direct sight in open field;
- » Front and rear tamper switch (tamper switch);
- » Microwave sensitivity adjustment (MW);
- » Supervised wireless communication;
- » Encrypted transmission;
- » Sensor configuration through applications;
- » Immunity to crawling animals weighing less than 20 kg;
- » Immunity to white light up to 10,000 lux;
- » Ease of installation.

### 3. Product

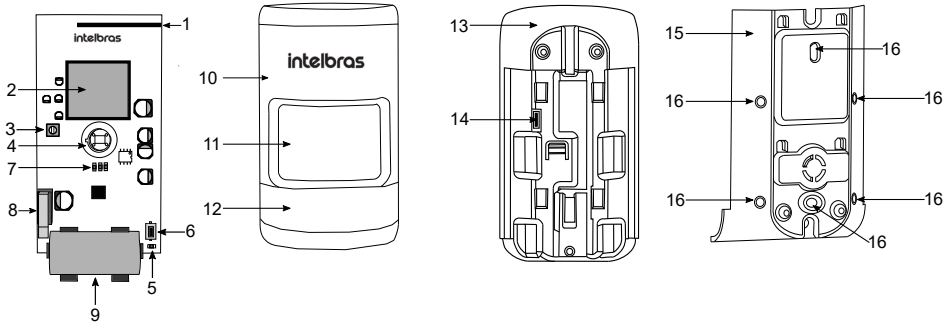

- 1. Antenna
- 2. Microwave Module
- 3. Microwave adjustment Trinpot
- 4. PIR Sensor
- 5. Status LED
- 6. Synchronization Button
- 7. LEDs
- 8. Front Tamper Switch
- 9. Battery connector
- 10. Front cover
- 11. Fresnel lens
- 12. Lower front cover
- 13. Base
- 14. Rear tamper switch
- 15. Bracket
- 16. Seal for installation screw

### 4. Sensor aperture

To access the IVP 8000 MW Pet sensor board for registration, changing the battery or removing it from the control panel, remove the lower front cover. See image below:

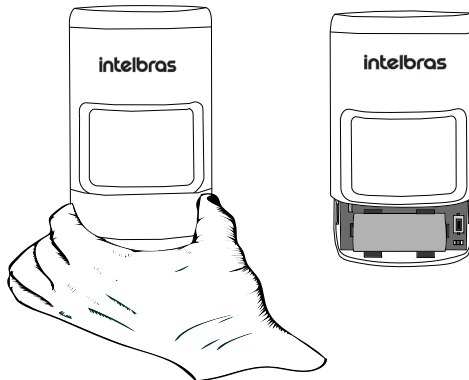

## 5. Sensor stabilization

---

After inserting the battery, the sensor goes into stabilization mode and the blue LED flashes for a few seconds. When stabilization is complete, the blue LED will stop flashing.

## 6. Registering the sensor

---

Sensor registration can be performed using the AMT Remote Desktop programming software, the AMT Remote Mobile application, keypad commands, or the synchronization button on the alarm control panel.

When registering via the control panel's synchronization button, the sensor addresses follow the registration sequence, e.g., the first sensor will be registered in zone 1, the second sensor in zone 2, and so on. For other registration methods, please consult the alarm control panel manual.

1. Press the synchronization button on the alarm control panel;
2. LED 3 on the control panel will remain lit for 3 minutes, indicating that it is waiting for the sensor to be registered;
3. Connect the battery and wait for the sensor to stabilize;
4. Press the sensor synchronization button;
5. The status LED will flash green indicating successful registration. If it flashes red, registration was not successful and the procedure must be repeated.

## 7. Deleting the sensor record

---

To remove the device from the control panel, two steps are necessary, one directly on the sensor and the other on the control panel.

- » **Sensor:** press and hold the sensor timing switch for approximately 10 seconds, watching the status LED blink red twice slowly.
- » **Alarm control panel:** enter the programming mode and type the command below:

01 to 64  
|  
Enter + 71 + zone no. + Enter

For other ways to remove the alarm center sensor, please consult the complete alarm center manual.

## 8. Identifying the best location for installation

The sensor has signal strength indicators for communication with the control panel, to help in choosing the best installation location. Follow the procedure:

1. With the sensor already registered in the alarm control panel, position it in the exact location where it will be installed. Verify the position where the sensor can cover the entire area, respecting the recommended installation height;
2. Position the sensor in the exact location where it will be installed and perform a transmission through a detection or the opening of the tamper;
3. Observe the color of the status LED to determine the most suitable location for installation.

LED status	level of communication
Green	Excellent signal level (recommended installation location)
Orange	Local regular signal level not recommended for installation (communication failure may occur)
Red	No communication (do not install on site)

If the signal level is not excellent, reposition the sensor or use a REP 8000 repeater and perform the procedure again. For more information about the REP 8000 repeater, consult the manual on the website: [www.intelbras.com.br](http://www.intelbras.com.br).

## 9. Installation

After identifying the best installation location, follow the recommendations:

- » It must be installed at a height of 1.8 m to 2.2 m and positioned so that the intruder makes transverse movements to the sensor's detection radius.
- » It is not recommended to install the sensor tilted up or down as this may impair its PET or detection function.
- » Make sure the sensor is securely fixed and not subject to jitter in order to avoid unwanted triggers.
- » Do not install microwave-based sensors close to each other, as this may cause interference between them.

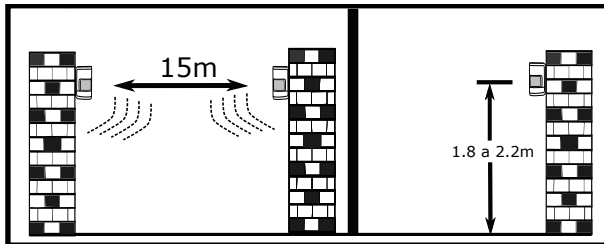

The IVP 8000 MW Pet sensor does not have an articulator. Therefore, for its installation, follow the procedure:

1. Remove the lower front cover and remove the rear bracket from the base by sliding it downwards, as shown in the picture.

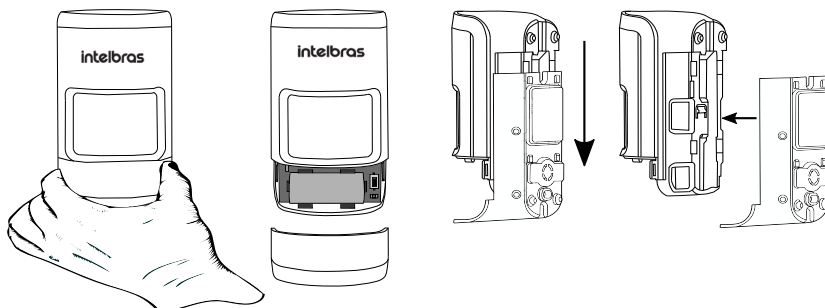

2. For installation directly on the wall or in a corner of the wall, break the indicated seals for the holes in the bracket.

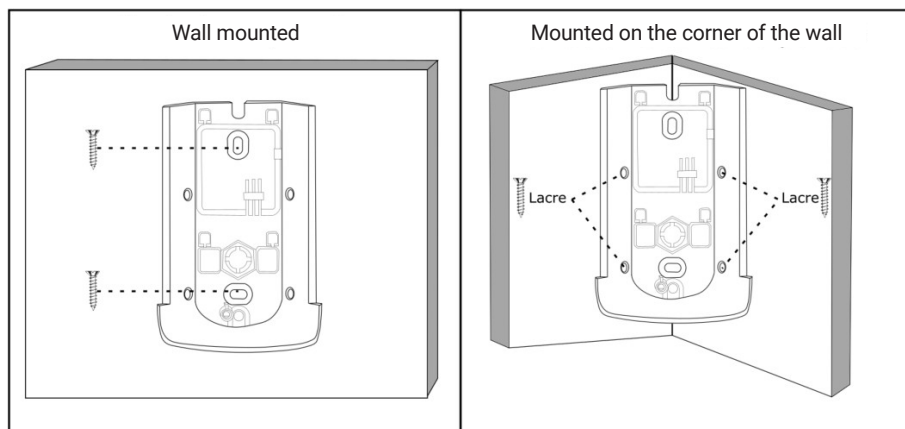

3. After fixing the bracket, fit the base on the bracket and slide it down and then fit the lower front cover.

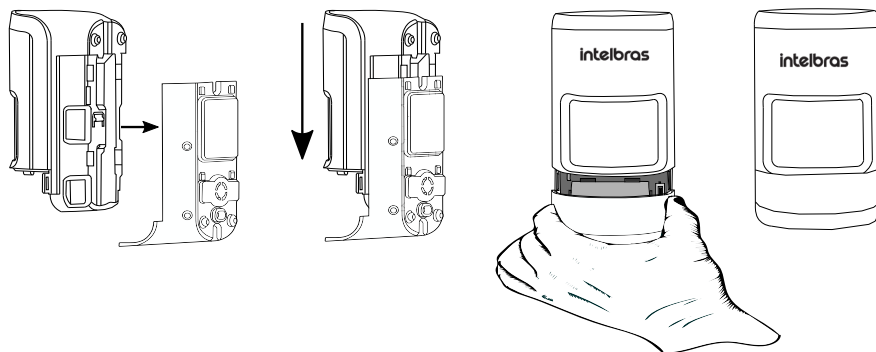

## 10. Trial period

The sensor enters test mode for 15 minutes after registering it with the alarm control panel or pressing the synchronization button, allowing for positioning adjustments. During this period, any motion detection will cause the blue LED to light up and trigger an alarm, regardless of the applied settings.

## 11. Test

Once installed and running, walk across the area to be protected simulating a possible intrusion into the environment. Check if the sensor is able to detect your movements during the course, through the Blue LED (triggering). Adjust the sensitivity if necessary or reposition the sensor. Be sure to take all precautions and follow installation recommendations to get the best operating performance from your product.

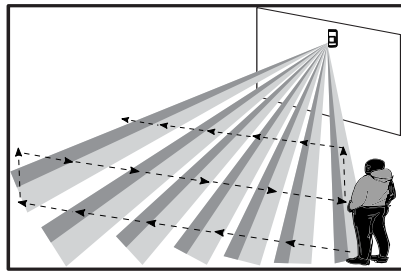

## 12. Configuring the sensor

Sensor settings can be performed via keyboard, software or application. The configured functions are:

- » Detection sensitivity.
- » Motion detection LEDs.
- » Operation mode.

The configuration will only actually be applied to the sensor after communication with the control panel, whether through a trip, activating the tamper or pressing the synchronization button.

The settings may vary according to the sensor version, the differences are exemplified below.

### 12.1. Configuring the sensor via the keyboard

Using the alarm control panel keypad, enter programming mode with the installer password, then type the following command:

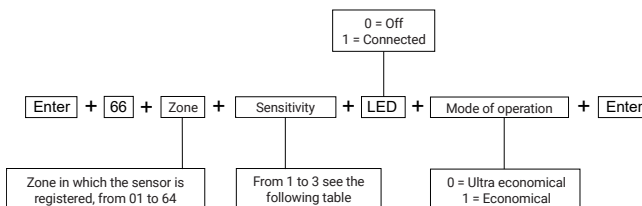

## 12.2. Information about sensor adjustments

Sensitivity adjustment table.

Level	Condition
1	Maximum sensitivity
2	Medium sensitivity (factory default)
3	Minimum sensitivity

## 12.3. Information about LED operation and mode of operation

- » **Off:** LED does not light. Factory standard.
- » **On:** LED will light on every sensor detection.

### Operation mode

- » **Economical:** when detecting movement, it turns on the LED, generates the trigger and goes into hibernation, remaining for a period that can last from 30 seconds (environment with little movement) to 2 minutes (environment with a lot of movement). During this sleep period the LED is not activated and no new triggers are generated, as a notification has just been sent to the control panel. After the hibernation period, the sensor monitors the environment again until a new movement is detected.

This ability to learn from the movement of the environment means that in places with a lot of movement, periodic and non-continuous shots are generated, in turn, saving battery life.

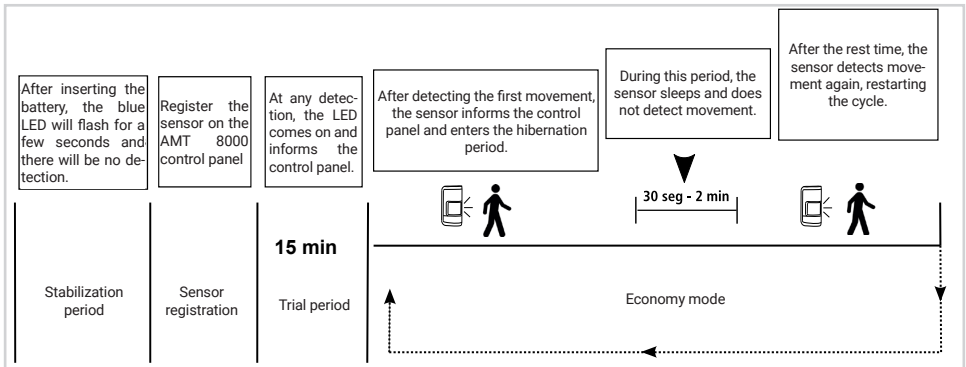

- » **Ultra Economical:** the sensor does not detect movements in the environment while the control panel is disarmed. Only communication with the alarm control panel. Factory standard.



The operating modes are valid only for the panel disarmed and after the test period. After arming the control panel, it is necessary to wait up to 3 minutes for the sensor to continuously detect movement. After the test period, the activation of the detection LED will be conditioned to the configuration enabled in the control panel.

## 12.4. Configuring the sensor through the app

After the application is properly connected to the alarm panel, select Configure panel on the main screen of the App.

Menu	
Configure center	>
Online	>
Events	>

Then select sensors:

Settings	
General	>
Zones	>
Passwords	>
Communication	>
Event codes	>
IP monitoring	>
ethernet/wifi	>
GPRS	>
Scheduled activation/deactivation	>
Sensors	>

Once this is done, select the sensor you want to configure. Example: sensor 1.

Sensors	
Sensor 1	>
Sensor 2	>
Sensor 3	>
Sensor 4	>
Sensor 5	>
Sensor 6	>
Sensor 7	>
Sensor 8	>
Sensor 9	>
... Sensor 64	>

After selecting the sensor, the following adjustment screen will open.

Sensor 1	
<b>Sensitivity</b>	
Level 1 (maximum sensitivity)	<input type="radio"/>
Level 2 (medium sensitivity)	<input checked="" type="radio"/>
Level 3 (minimum sensitivity)	<input type="radio"/>
<b>LED</b>	
Always off	<input checked="" type="radio"/>
On when shooting	<input type="radio"/>
<b>Operation mode</b>	
Ultra economical mode	<input checked="" type="radio"/>
Economy mode	<input type="radio"/>
Discard changes	Save

## 12.5. Microwave sensitivity adjustment

To adjust the microwave's sensitivity, you need to remove the two front covers of the sensor. To do this, follow the steps below:

1. Remove the bottom front cover (battery cover);
2. Remove the top front cover by inserting a screwdriver, as shown in the image below;

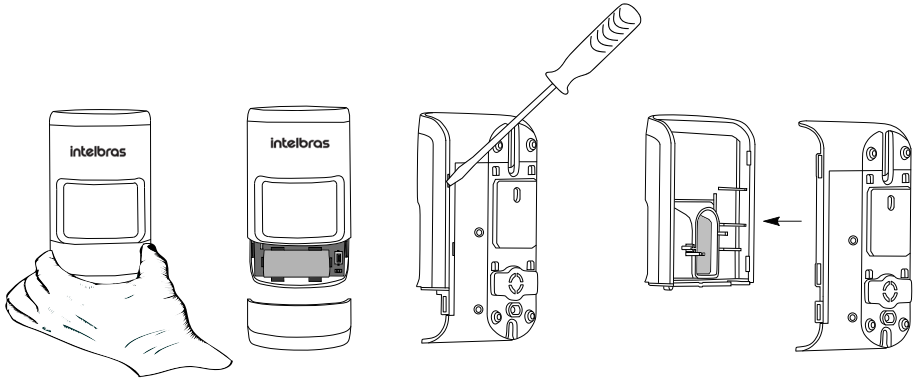

The microwave's sensitivity adjustment is done on the product's control board using a potentiometer, as shown in the image below.

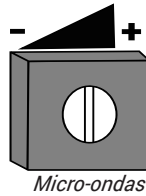

Turning the trimpot clockwise increases the sensitivity and consequently the distance at which the microwave can detect movement. Turning it counter-clockwise makes the microwave less sensitive.

**Note:** it is highly recommended to adjust the microwave's sensitivity so that detection only occurs in the area where the sensor is installed. This technology is capable of detecting movement through a wall, for example.

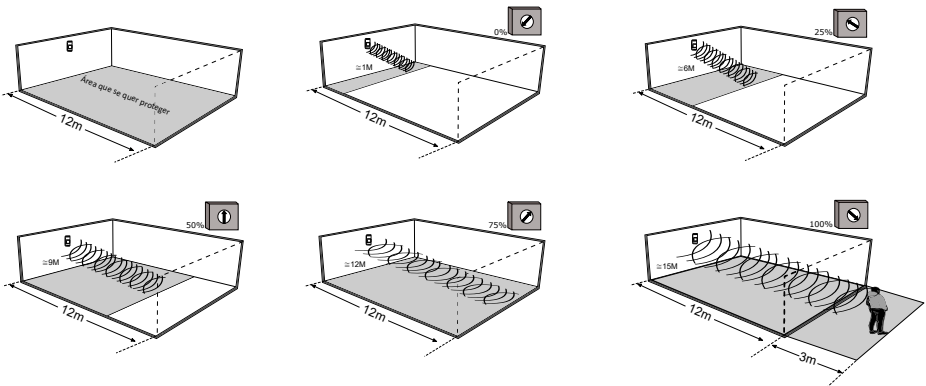

In figure 1 of the example above, we have the area we want to protect. Figure 6 indicate that the trimpot adjustment has exceeded the limits of the area to be protected. In this way, the microwave will detect movements outside the desired area.

To facilitate the adjustment of the microwave coverage, adjust the trimpot counterclockwise (less sensitive) and walk around the area you want to protect. Observe the sensor's motion detection. If necessary, increase the sensitivity (clockwise). Repeat this process until the sensor protects only the area where it is installed.

The figure below shows a reference range for the microwave channel detection. Factory default: 50

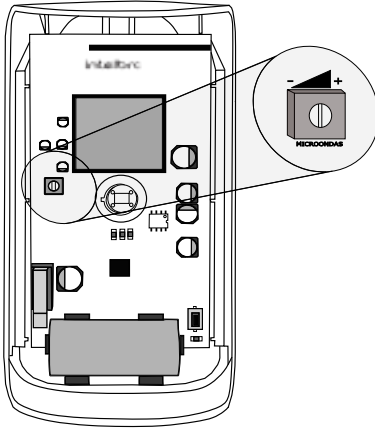

Microwave range	
Trimpot position	Maximum distance (meters)
0%	0% - up to 1 meter
25%	25% - up to 6 meters
50%	50% - up to 9 meters
75%	75% - up to 12 meters
100%	100% - up to 15 meters

## 13. Battery

---

The sensor monitors the battery level and sends low battery information to the alarm control panel, indicating that the battery must be replaced.

Use only quality batteries that are sized correctly for the device. The estimated useful life for the battery is 3 to 5 years, and may be influenced by the number of activations, weather conditions and sensor configuration mode.

We recommend replacing batteries with the same brand and industrial model as purchased from factory products.

**Attention:** we recommend replacing batteries with Panasonic Industrial, Duracell High Power or GP Pro brands and models.



Battery-powered product. Dispose of at authorized Intelbras sites or at collection points specifically designed for this purpose. It can cause risk to human health and the environment. Questions: [www.intelbras.com.br](http://www.intelbras.com.br), [support@intelbras.com.br](mailto:support@intelbras.com.br) or (48) 2106-0006 or 0800 704 2767.

---

## 14. Battery replacement

---

Para substituir a bateria do produto:

- » Remove the discharged battery.
- » Press the timing switch for complete circuit discharge.
- » Insert the new battery.

## 15. Homologation

---



This equipment is not entitled to protection against harmful interference and may not cause interference in duly authorized systems. This is a product approved by Anatel, the approval number can be found on the product label, for inquiries visit the website: <https://www.gov.br/anatel/pt-br>

## Warranty term

---

It is expressed that this contractual guarantee is granted under the following conditions:

---

Client name:

Customer's signature:

Invoice number:

Purchase date:

Model:

Serial number:

Dealer:

---

1. All parts, pieces, and components of the product are warranted against any manufacturing defects, which may present, for a period of 1 (one) year – 90 (ninety) days of legal warranty and 9 (nine) months of contractual warranty –, as of the date of purchase of the product by the Consumer, as stated in the invoice for the purchase of the product, which is an integral part of this Term throughout the national territory. This contractual guarantee includes the free exchange of parts, pieces, and components with a manufacturing defect, including labor expenses in the repair. If no manufacturing defect is found, but a vice arising from improper use, the Consumer shall bear such expenses.
2. The product must be installed according to the Product Manual and/or Installation Guide. If your product requires installation and configuration by a qualified technician, look for a suitable and specialized professional, and the costs of these services are not included in the price of the product.
3. Once the defect is found, the Consumer must immediately contact the nearest Authorized Service in the list provided by the manufacturer – only these workshops are authorized to examine and solve the defect during the warranty period provided for herein. If this is not respected, this guarantee will lose its validity, as it will be characterized as a product violation.
4. In the event that the Consumer requests home service, it should go to the nearest Authorized Service for consultation of the technical visit fee. If the product needs to be withdrawn, the resulting expenses, such as transportation and safety in the product's trips, are under the responsibility of the Consumer.
5. The warranty will be totally void in any of the following events: a) if the defect is not a manufacturing defect, but caused by the Consumer or by third parties foreign to the manufacturer; b) if the damage to the product comes from accidents, acts of God (lightning, floods, landslides, etc.), humidity, voltage in the electrical network (overvoltage caused by accidents or excessive fluctuations in the network), installation/use in disagreement with the user manual or due to the natural wear and tear of parts, pieces, and components; c) if the product has been influenced by a chemical, electromagnetic, electrical, or animal nature (insects, etc.); d) if the product's serial number has been tampered with or erased; e) if the device has been tampered with.
6. This warranty does not cover data losses, therefore, it is recommended that the Consumer regularly back up the data contained in the product, if applicable.
7. Intelbras is not responsible for the installation of this product, and also for any attempted fraud and/or sabotage of its products. Keep software and applications updates up to date, if applicable, as well as the required network protections to protect against intrusions (hackers). The equipment is warranted against vices within its normal conditions of use, it is important to be aware that, as in any electronic equipment, it is not free from fraud and scams that may interfere with its correct operation.
8. Properly dispose of your product after its useful life - deliver it to collection points for electrical and electronic products, at an authorized Intelbras technical assistance center or consult our website [www.intelbras.com.br](http://www.intelbras.com.br) and [support@intelbras.com.br](mailto:support@intelbras.com.br) or (48) 2106-0006 or 0800 7042767 for more information.

These being the conditions of this complementary Warranty Term, Intelbras S/A is entitled to the right to change the general, technical, and aesthetic characteristics of its products without prior notice. All images in this manual are illustrative.

# intelbras

---



*talk to us*

**Customer Support:**  +55 (48) 2106 0006

**Forum:** [forum.intelbras.com.br](http://forum.intelbras.com.br)

**Support via chat:** [chat.apps.intelbras.com.br](http://chat.apps.intelbras.com.br)

**Support via e-mail:** [suporte@intelbras.com.br](mailto:suporte@intelbras.com.br)

**Customer Service / Where to buy? / Who installs it?:** 0800 7042767

Produced by: Intelbras S/A – Indústria de Telecomunicação Eletrônica Brasileira  
Rodovia BR 459, km 126, nº 1325 – Distrito Industrial – Santa Rita do Sapucaí/MG – 37538-400  
CNPJ 82.901.000/0016-03 – [www.intelbras.com.br](http://www.intelbras.com.br) | [www.intelbras.com/en](http://www.intelbras.com/en)

01.26  
Made in Brazil