

The Intelbras logo, featuring the word "intelbras" in a green, lowercase, sans-serif font. The background is light gray with large, faint, white abstract shapes resembling the letters 'E' and 'U'.

Intelbras

PSR600-54A-B

**Power Supply User
Manual**

Intelbras PSR600-54A-B Power Supply User

Overview

- The PSR600-54A-B is a DC output power supply that supports AC and HVDV power input. It provides a maximum output of 600 W.
- The PSR600-54A-B power supply exhausts air from its faceplate. The following figure shows the PSR600-54A-B power supply

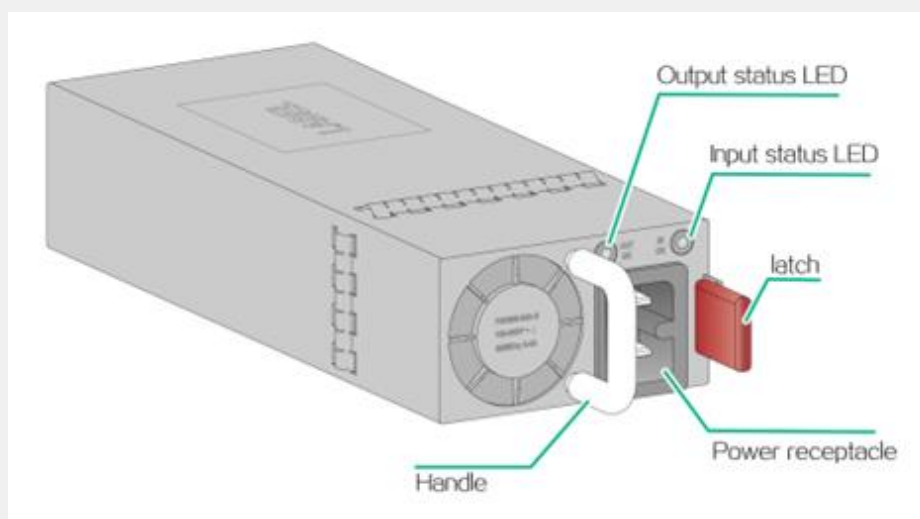

- The PSR600-54A-B power supply is applicable to multiple switch models. The applicable switch models might change over time. For compatibility of the power supply with switch models, contact the marketing personnel or technical support.
- The restrictions for using the PSR600-54A-B power supply depend on the switch model. For more information, see the installation guide or hardware information and specifications for the switch.

Feature	Description
Self-protection	Provide input undervoltage, output overvoltage, short-circuit, output overcurrent, and overtemperature protections.

Feature	Description
Redundancy	Two power supplies can be connected in parallel to achieve 1+1 redundancy and load sharing.
Hot swappable	You can remove one of power supplies in 1+1 redundancy while the device is operating. Before removing the power supply, disconnect the power supply from the external power supply system.

A power supply shuts down after an input undervoltage, short circuit, output overcurrent, or overtemperature condition occurs. After the issues are resolved, it automatically restores power supply.

A power supply shuts down and is locked after an output overvoltage condition occurs. It cannot restore power supply automatically after the issue is resolved. To restore power supply, perform the following tasks:

- Disconnect the power cord from the external power supply system.
- Disconnect the power cord from the power supply and then reconnect it.
- Connect the power cord to the external power supply system.

Technical specifications

Item		Specifications
AC input	Rated input voltage range	100 to 240 VAC @ 50/60 Hz
	Max input voltage range	90 to 290 VAC @ 47 to 63 Hz
	Max input current	9 A
HVDC input	Rated input voltage range	240 VDC
	Max input voltage range	180 to 320 VDC
	Max input current	5 A
Output voltage		56 V
Max output current		11 A
Max output power		600 W
Dimensions (H × W × D)		40.2 × 73.5 × 185 mm (1.58 × 2.89 × 7.28 in)
Weight		1 kg (2.20 lb)

Item	Specifications
Operating temperature	–10°C to +55°C (14°F to 131°F)
Relative humidity	5% RH to 95% RH, noncondensing
Storage temperature	–40°C to +70°C (–40°F to +158°F)

LEDs

The PSR600-54A-B power supply provides two LEDs on its faceplate to indicate the power input and output status.

LED	Mark	Status	Description
Output status LED	OUT OK	Steady green	Normal power output.
		Steady red	Abnormal power output.
		Off	No power output.
Input status LED	IN OK	Steady green	Normal power input.
		Steady red	Abnormal power input.
		Off	No power input.

Installing and removing the power supply

Safety precautions

- Wear an ESD wrist strap and make sure the wrist strap makes good skin contact.
- Before installing the power supply, make sure the operating voltage of the external power supply system is as required by the power supply, and the output voltage of the power supply is as required by the powered device.
- To avoid bodily injury, do not touch any bare wire or terminal

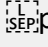
- To avoid power supply damage, do not open the power supply. When the internal circuits or components of the power supply fail, contact Intelbras Support.
- Before installing or removing the power supply, make sure no power cord is connected to the  power supply.

Tools

An ESD wrist strap is required for installing and removing the power supply and connecting the power cord. Prepare an ESD wrist strap yourself.

Installing the power supply

- Keep the filler panel, packaging box, and packaging bags for the power supply secure for future use.
- Before installing the power supply on a switch, make sure it matches the switch model. For more information, see the installation guide for the switch.
- To prevent damage to the power supply or the connector on the backplane of the powered device, insert the power supply gently.
- If you insert the power supply upside down, you will encounter a hard resistance because of the special structure designs of the slot and power supply. You need to pull out the power supply, orient it correctly, and insert it again.

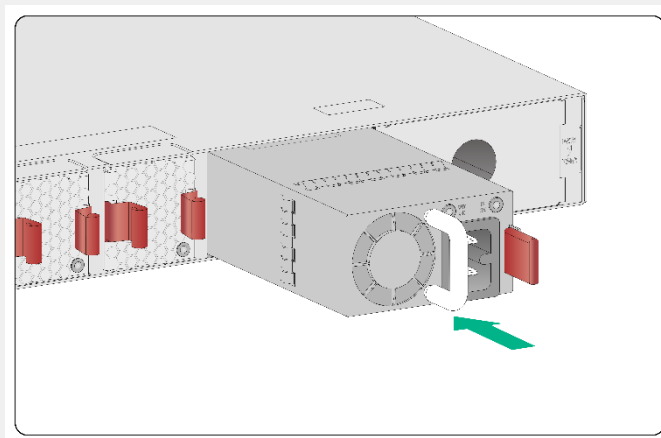

- (1) Unpack the power supply and verify that the input mode of the power supply is as required.
- (2) Correctly orient the power supply (with the lettering on it upward), grasp the handle of the power supply with one hand and support its bottom with the other, and slide the power supply slowly along the guide rails into the slot. Make sure the latch on the power supply clicks into place.

If the power supply slot has a filler panel, put your finger into the hole in the filler panel and then pull the filler panel out of the slot gently.

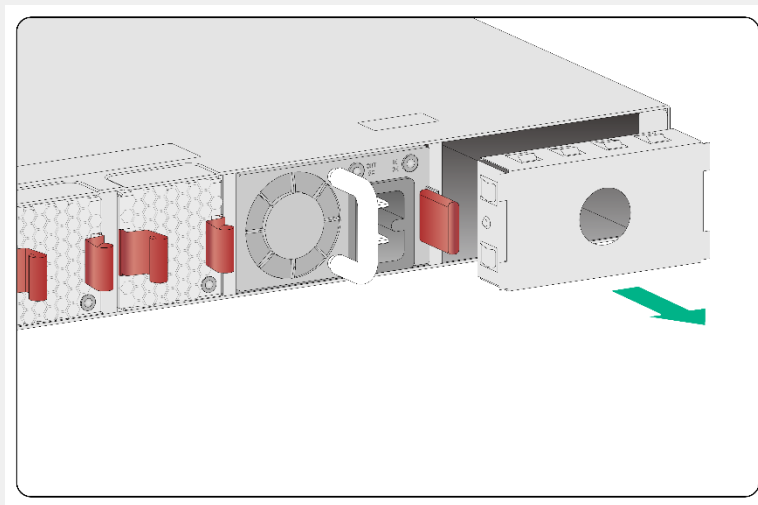

Connecting the power cord

- Use the power cord provided with the power supply for connection. The power cord provided with the power supply uses a C15 connector that is designed to withstand high temperatures.
- Provide a separate circuit breaker for each power cord.

- Before connecting a power cord, make sure the circuit breaker for the power feed is turned off.

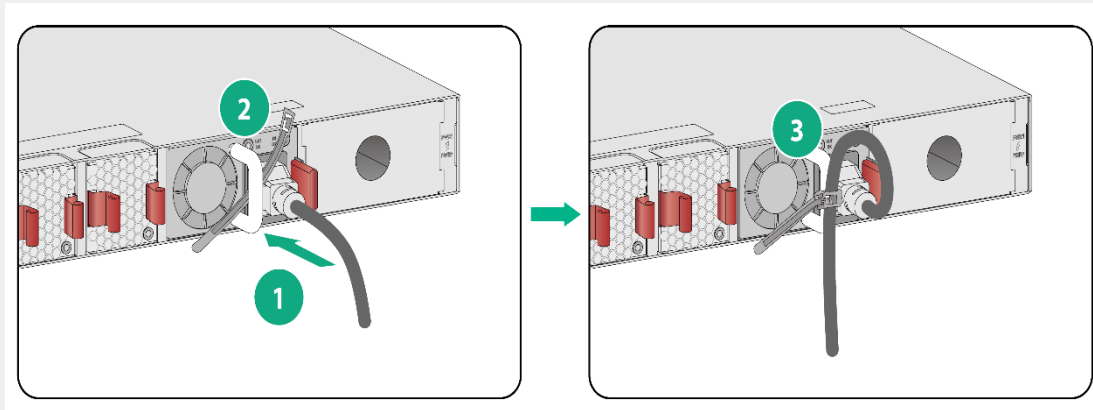

- (1) Connect the female connector of the power cord to the power input receptacle on the power supply.
- (2) Use a cable tie to secure the power cord to the handle of the power supply.

Removing the power supply

- To avoid bodily injury or switch damage, strictly follow the procedure described in this section to remove the power supply.
- If you are not to install a new power supply after removing the old one, install a filler panel in the slot in time.

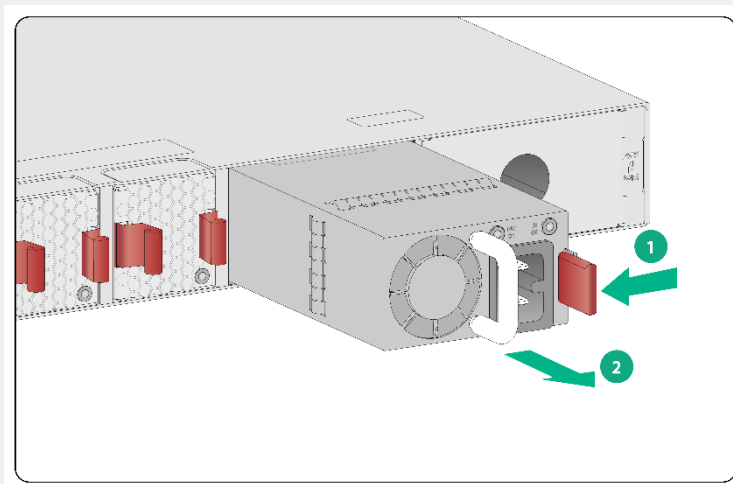

- (1) Turn off the circuit breaker for the power feed to the power supply.
- (2) Remove the cable tie from the power cord, and then remove the power cord.

- (3) Pressing the latch towards the handle direction, pull the power supply part way out of the slot.
- (4) Grasping the handle of the power supply with one hand and supporting its bottom with the other, pull the power supply slowly out of the slot along the guide rails.
- (5) Put the removed power supply into an antistatic bag.

Compatible with: SC 3570 Series and 5523 Series.

Box content:

1 x power supply
1 x 3.0 meters Brazil standard (NBR 14136) power cable

