

English

intelbras

User manual

IVP 5000 LD

intelbras

IVP 5000 LD

Passive infrared motion sensor

Congratulations, you have just purchased a product with Intelbras quality and safety.

The IVP 5000 LD motion sensor features passive infrared motion detection technology, with advanced signal analysis technology that prevents accidental triggering.

Care and safety

- » Follow all instructions in the manual for assembly and installation of the product.
- » LGPD – Data processing by Intelbras: Intelbras does not access, transfer, capture or carry out any type of processing of personal data using this product.
- » This product is intended for INDOOR environments.

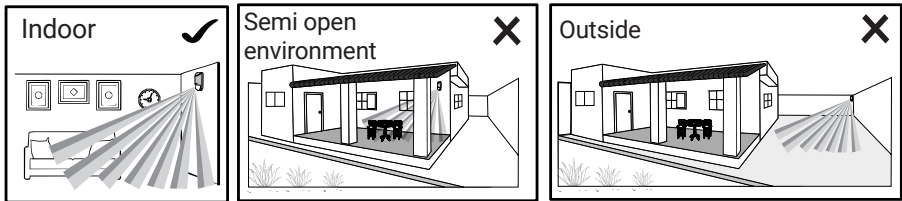

- » Do not touch the surface of the infrared (PIR) sensor. If necessary, use a soft, dry cloth for cleaning.
- » Do not use the sensor in areas with sudden changes in temperature, such as near air conditioning, heaters, fans, refrigerators and ovens. Do not expose the sensor directly or to reflected sunlight.

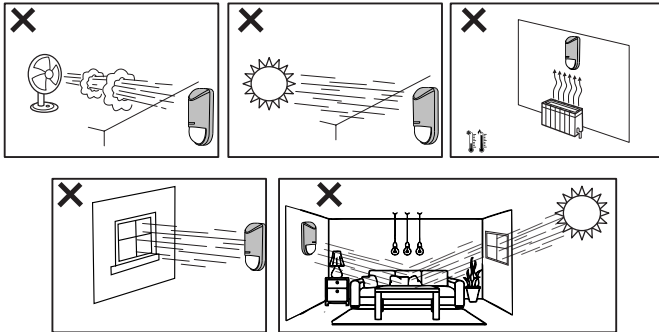

- » The *PET* function is intended for crawling animals weighing up to 15 kg. If the animal is on a bench, for example, the *PET* function can be canceled. The presence of more than one animal in the environment can compromise the efficiency of the *PET* function.

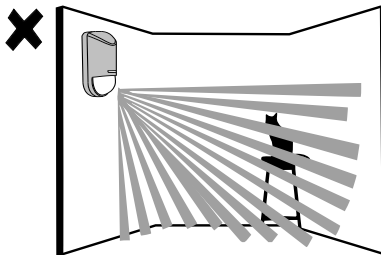

- » Do not place objects in front of the sensor. Avoid curtains, screens, screens, or any object that blocks the sensor's detection area.
- » Do not install the sensor facing infrared sources, for example cameras.

- » The sensor must be installed where the intruder can be easily detected, that is, where it makes movements transverse to the detection beams.

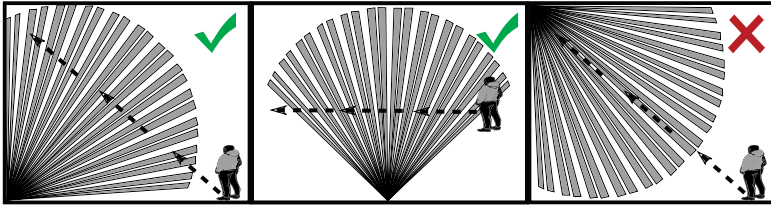

- » The sensor must be installed on a flat, fixed and vibration-free surface, with a height between 2.0 and 2.80 meters. It is recommended to install the sensor parallel to the wall for the greatest detection range.

Detection area (Top view)

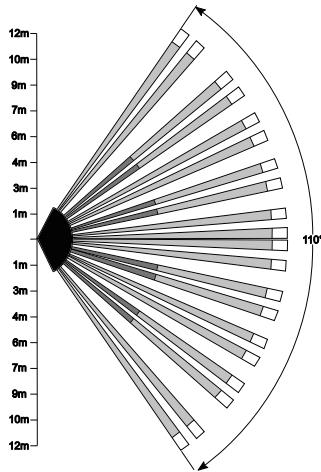

Detection angle (Side view)

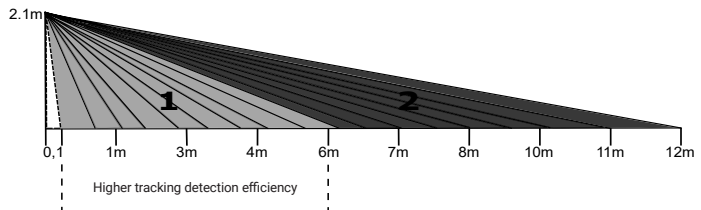
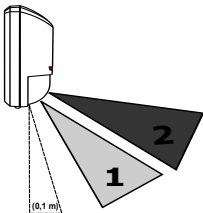
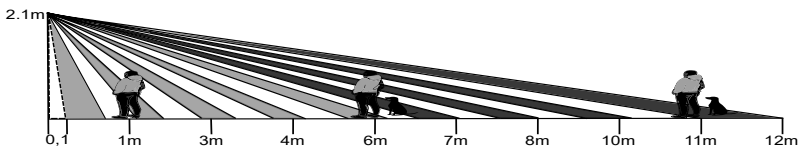

Summary

1. Technical specifications	6
2. Characteristics	6
3. Product	7
3.1. Support	8
4. Installation	8
4.1. Installation using the articulator	10
4.2. Installation using XSA 1000 ¹	12
5. Operation	15
6. Test	15
Warranty term	16

1. Technical specifications

Operating voltage	9 ~16 Vdc
Operating current	13 mA
Detection angle	110°
Detection range	12 meters
Detection method	PIR
Animal immunity	Up to 15 kg
Pyrosensor model	QUAD
Sensitivity adjustment	3 levels (1P – 2P – 3P)
Alarm output	NC, 28 Vdc and 100 mA max.
Startup time	Up to 60 seconds
Relay opening time	3 seconds
Operating Temperature	-10°C to 50°C
Installation height range	2.0 to 2.80 meters
Recommended installation height	2.10 meters
Dimensions (W x H x D)	58x123x44mm
Weight	122 g

2. Characteristics

- » Anti-tamper (tamper key);
- » Automatic temperature compensation;
- » RFI/EMI immunity;
- » Infrared (PIR) sensitivity adjustment;
- » Immunity to creeping animals weighing less than 15 kg.

3. Product

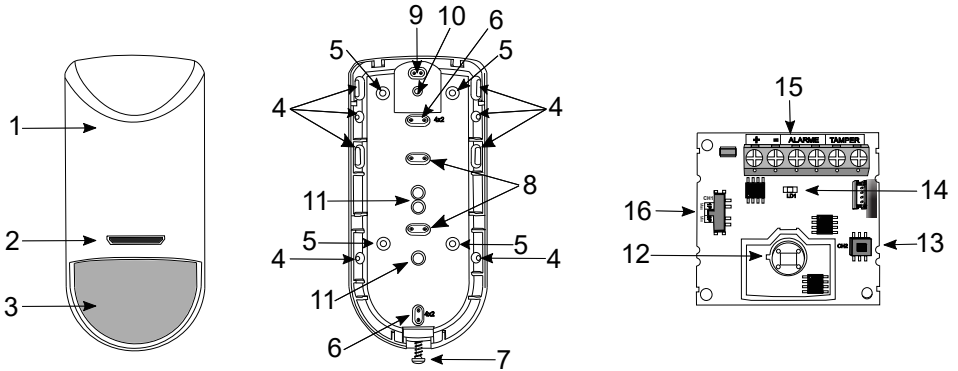

1. Front cover
2. LED driver
3. Semi-spherical lens
4. Seals for corner installation
5. Seals for wall installation
6. Seals for installation in 4x2 box
7. Closing screw
8. Wire passage seals or wall installation
9. Wire passage seal
10. Seal for fixing the articulator
11. Drilling for installation of the XSA 1000 bracket or universal bracket
12. Pyro sensor
13. Tamper wrench
14. Blue LED
15. Terminal block
16. Sensitivity selector switch

3.1. Support

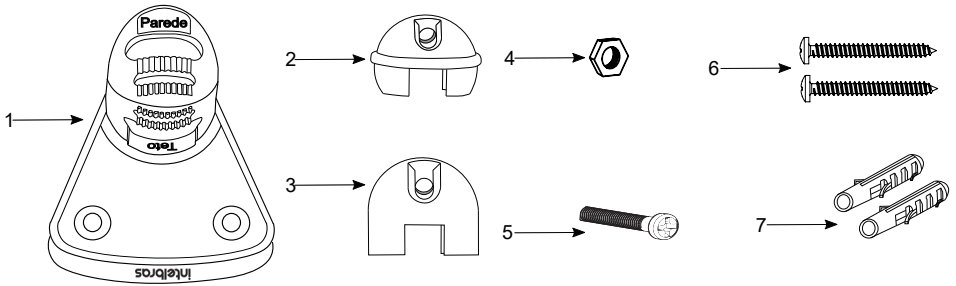

1. Support base
2. Adapter for wall installation
3. Adapter for ceiling installation
4. M3 hex nut
5. M3x20 mm screw (fine thread)
6. Fixing screw 3.5x25 mm
7. 6 mm fixing bushing

4. Installation

- » Before starting installation, it is necessary to define the height at which the sensor will be positioned, which can vary from 2.0 to 2.8 m;
- » The sensor must be installed on a flat, fixed and vibration-free surface;
- » For installation using the articulator, make sure that both the sensor and the support are firmly fixed in the installation location to avoid changes in the product's detection angle. Incorrect use of the articulator can alter the sensor's detection area, creating blind spots and impairing operating efficiency;
- » If the sensor is installed at an angle, its detection range and *PET* function may be impaired to the point of nullifying the function.

To install the sensor, follow the procedure below:

1. Remove the front cover of the sensor using a Philips screwdriver. It is not necessary to remove the entire screw, as shown in the image.

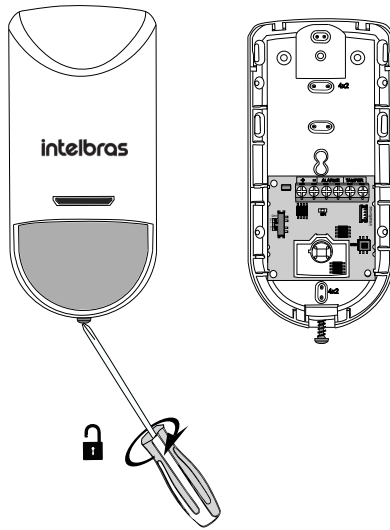

2. Use the markings on the sensor base for cable routing and necessary connections. Note item 3 that there are other options for routing the cable. Use the one that best suits the installation.

Note: use a tool to make the hole in the indicated location.

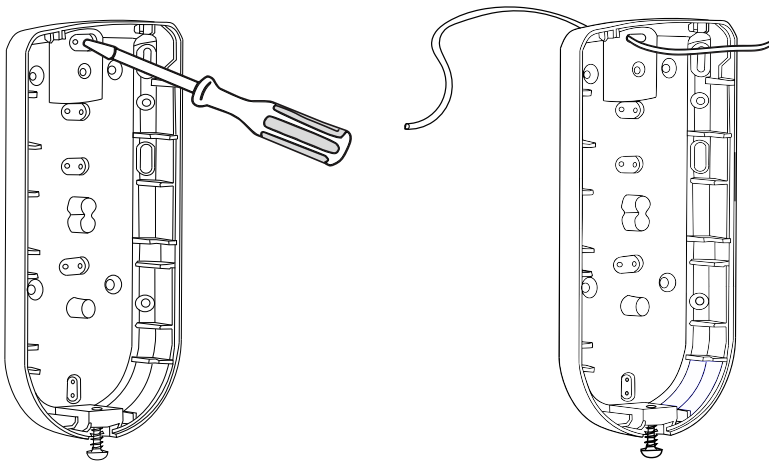

3. For installation directly on the wall, 4x2 box or in a wall corner, remove the seals indicated for the holes in the rear fixing cover.

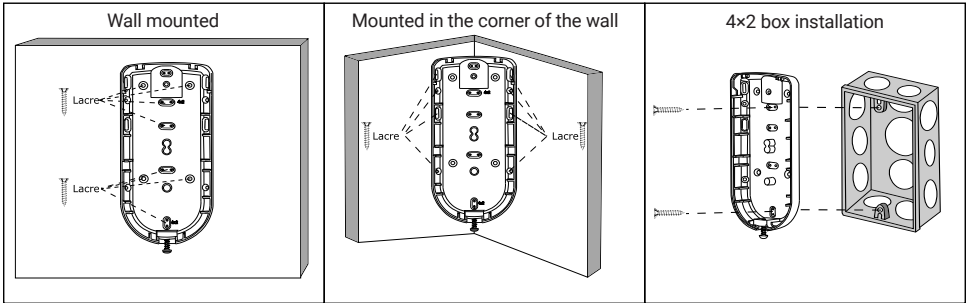

4.1. Installation using the articulator

Attention: installing the sensor at an angle to the ground may compromise the performance of the *PET* function.

- » Use the fixing holes located on the base to fix the articulator;
- » The recommended screw for fixing articulators to the product is M3 × 20 mm.

Installing the articulator on the wall

1. Remove the cable passage seal and the articulator fixing seal;
2. Using a pair of pliers, place the nut in the housing on the wall adapter and then insert it into the base of the support. Note that the opening must be upwards as shown in image 2;
3. Route the cable through the stand and base of the product. Then fix the support to the wall;
4. Attach the base to the support and direct the product to the location you want to protect.

Note: the support only moves horizontally.

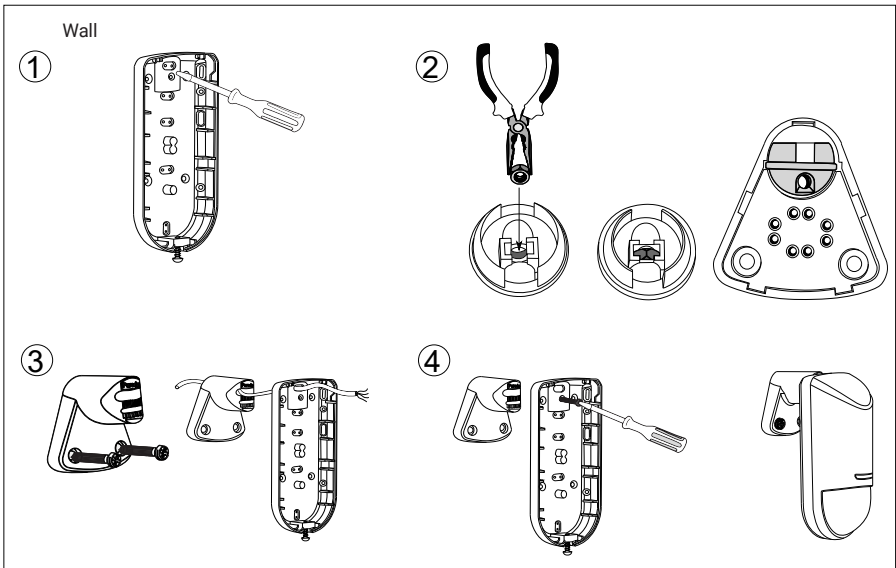

Installing the articulator on the ceiling

5. Remove the cable passage seal and the articulator fixing seal;
6. Using needle-nose pliers, place the nut in the housing on the ceiling adapter and then insert it into the base of the support. Note the correct position in image 2;
7. Pass the cable through the support and base of the product and then fix the support to the ceiling;
8. Attach the base to the support and direct the product to the location you want to protect.

Note: the support only moves horizontally.

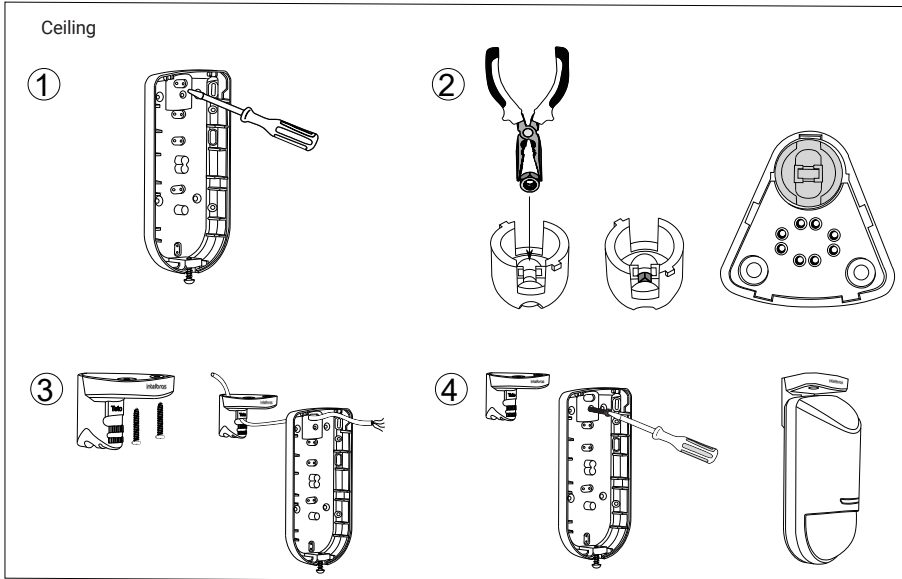

4.2. Installation using XSA 1000¹

Attention: if the fixing bracket is tilted in relation to the ground, the characteristics of the PET function will be altered.

Use the fixing holes located on the base to fix the XSA 1000 articulator. For more information about the XSA 1000 articulator, consult the user manual on the website: www.intelbras.com.br

The recommended screw for fixing articulators to the product is 3.5 × 9.5 mm.

¹ The articulator is not included with the product.

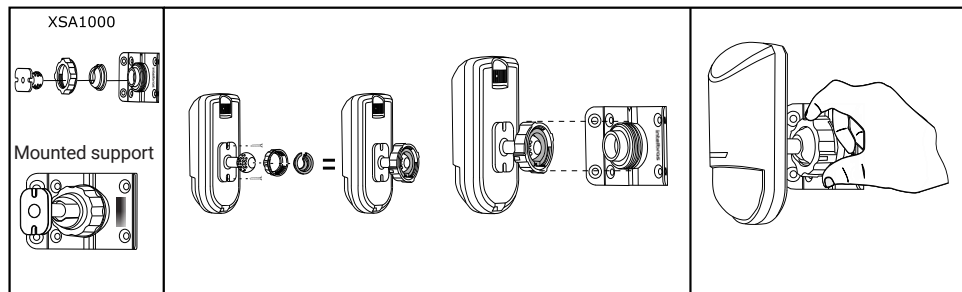

Sensitivity adjustment

The sensor has a selector switch for sensitivity adjustment, where it is possible to adjust between 3 detection levels.

- » **1P – Maximum sensitivity for movement detection:** recommended for use in controlled environments and for greater efficiency in detecting crawling.
- » **2P – Medium sensitivity (factory default).**
- » **3P – Minimum sensitivity for greater robustness against accidental shots:** recommended for use in harsh environments or with the presence of PET.

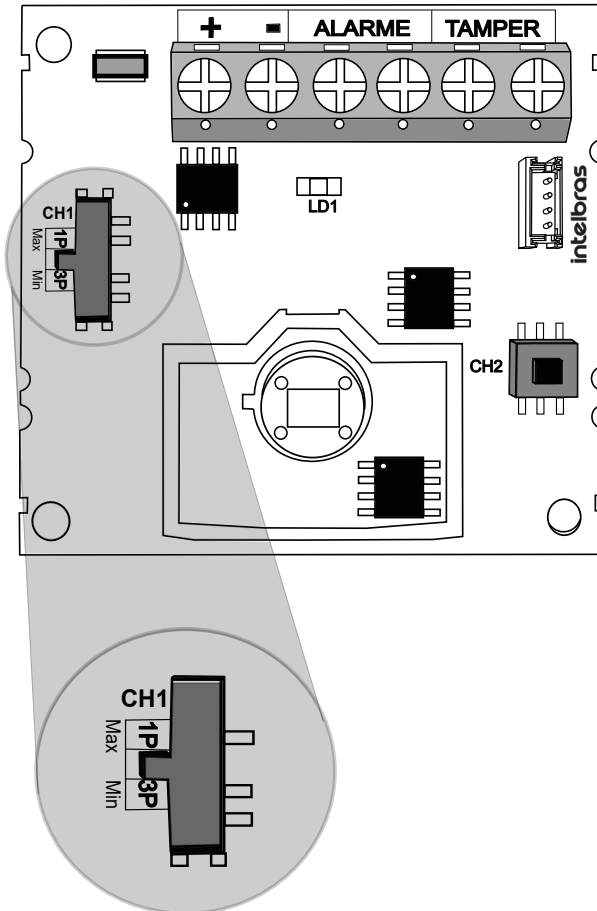

Completion of the process

Close the case, first fitting the top part of the front cover and going down perpendicularly towards the bottom of the sensor. Keep the front cover pressed against the base and tighten the screw.

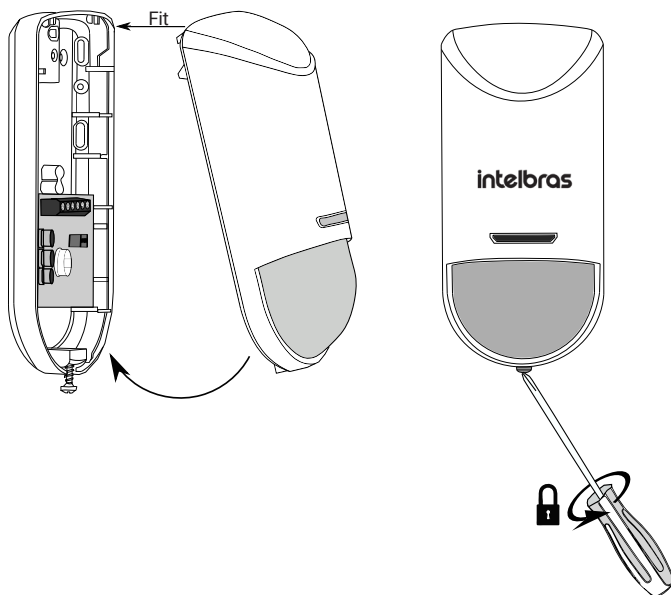

5. Operation

The sensor has a blue LED that signals the stabilization period and movement detections. During the stabilization period (approximately 60 seconds after powering the sensor), the LED continues to flash every second. After this period, the LED lights up for three seconds each time movement is detected.

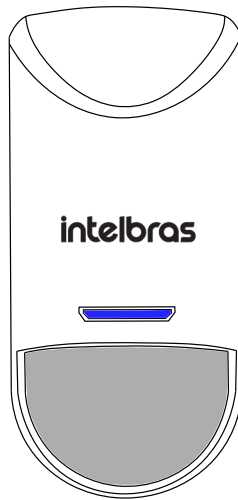

6. Test

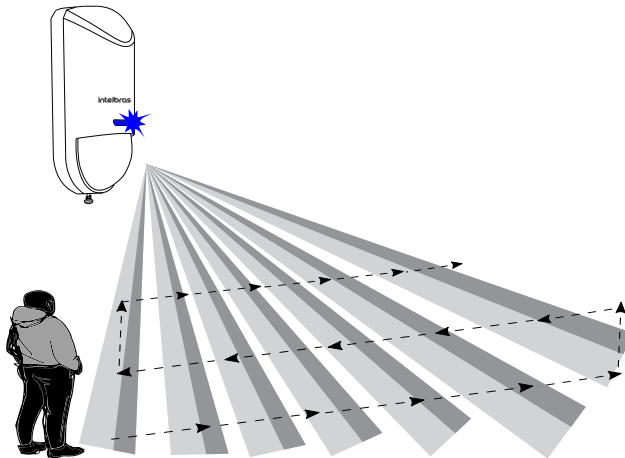

Once installed and in operation, walk across the entire area to be protected, simulating a possible intrusion into the environment. Observe whether the sensor is capable of detecting your movements during the journey, using the LED. Adjust sensitivity according to the environment or reposition the sensor. Be sure to take all precautions and follow installation recommendations to obtain the best operating performance from the product.

Warranty term

It is expressed that this contractual guarantee is granted under the following conditions:

Client name:

Customer's signature:

Invoice number:

Purchase date:

Model:

Serial number:

Dealer:

1. All parts, pieces, and components of the product are warranted against any manufacturing defects, which may present, for a period of 1 (one) year – 90 (ninety) days of legal warranty and 9 (nine) months of contractual warranty –, as of the date of purchase of the product by the Consumer, as stated in the invoice for the purchase of the product, which is an integral part of this Term throughout the national territory. This contractual guarantee includes the free exchange of parts, pieces, and components with a manufacturing defect, including labor expenses in the repair. If no manufacturing defect is found, but a vice arising from improper use, the Consumer shall bear such expenses.
2. The product must be installed according to the Product Manual and/or Installation Guide. If your product requires installation and configuration by a qualified technician, look for a suitable and specialized professional, and the costs of these services are not included in the price of the product.
3. Once the defect is found, the Consumer must immediately contact the nearest Authorized Service in the list provided by the manufacturer – only these workshops are authorized to examine and solve the defect during the warranty period provided for herein. If this is not respected, this guarantee will lose its validity, as it will be characterized as a product violation.
4. In the event that the Consumer requests home service, it should go to the nearest Authorized Service for consultation of the technical visit fee. If the product needs to be withdrawn, the resulting expenses, such as transportation and safety in the product's trips, are under the responsibility of the Consumer.
5. The warranty will be totally void in any of the following events: a) if the defect is not a manufacturing defect, but caused by the Consumer or by third parties foreign to the manufacturer; b) if the damage to the product comes from accidents, acts of God (lightning, floods, landslides, etc.), humidity, voltage in the electrical network (overvoltage caused by accidents or excessive fluctuations in the network), installation/use in disagreement with the user manual or due to the natural wear and tear of parts, pieces, and components; c) if the product has been influenced by a chemical, electromagnetic, electrical, or animal nature (insects, etc.); d) if the product's serial number has been tampered with or erased; e) if the device has been tampered with.
6. This warranty does not cover data losses, therefore, it is recommended that the Consumer regularly back up the data contained in the product, if applicable.
7. Intelbras is not responsible for the installation of this product, and also for any attempted fraud and/or sabotage of its products. Keep software and applications updates up to date, if applicable, as well as the required network protections to protect against intrusions (hackers). The equipment is warranted against vices within its normal conditions of use, it is important to be aware that, as in any electronic equipment, it is not free from fraud and scams that may interfere with its correct operation.
8. Properly dispose of your product after its useful life - deliver it to collection points for electrical and electronic products, at an authorized Intelbras technical assistance center or consult our website www.intelbras.com.br and support@intelbras.com.br or (48) 2106-0006 or 0800 7042767 for more information.

These being the conditions of this complementary Warranty Term, Intelbras S/A is entitled to the right to change the general, technical, and aesthetic characteristics of its products without prior notice. All images in this manual are illustrative.

intelbras



talk to us

Customer Support:  +55 (48) 2106 0006

Forum: forum.intelbras.com.br

Support via chat: chat.apps.intelbras.com.br

Support via e-mail: suporte@intelbras.com.br

Customer Service / Where to buy? / Who installs it?: 0800 7042767

Produced by: Intelbras S/A – Indústria de Telecomunicação Eletrônica Brasileira
Rodovia BR 459, km 126, nº 1325 – Distrito Industrial – Santa Rita do Sapucaí/MG – 37538-400
CNPJ 82.901.000/0016-03 – www.intelbras.com.br | www.intelbras.com/en

02.24
Made in Brazil